



HP xw6200 Workstation Disassembly Procedures

407686-001

October, 2005 Edition

1	PRODUCT END-OF-LIFE DISASSEMBLY INSTRUCTIONS	2
1.1	Product Identification	2
1.2	Purpose	2
1.3	Removal Items.....	2
1.4	Required Tools.....	3
2	WORKSTATION DISASSEMBLY PROCEDURES	4
3	POWER SUPPLY DISASSEMBLY PROCEDURES	8



1 Product End-of-Life Disassembly Instructions

This document describes the disassembly of an HP workstation for the removal of Annex-2 components.

1.1 Product Identification

The procedures in this document apply to the workstation identified in Table 1-1.

Table 1-1 Product ID

Marketing Name / Model	Description
HP xw6200 Workstation	Personal Workstation

1.2 Purpose

This document is for end-of-life recyclers or treatment facilities. It provides basic instructions for disassembling an HP workstation to remove components and materials that require selective treatment.

1.3 Removal Items

Table 1-2 lists the items to be removed.

Table 1-2 Removal Items

Item Description	Notes	Quantity of Items in Workstation
Printed Circuit Boards (PCB) or Printed Circuit Assemblies (PCA) with a surface greater than 10 square cm		Four—two in the power supply, one graphics card, and one system board. (Additional cards may be present depending on the configuration.)
Batteries	All types including standard alkaline and lithium coin or button style batteries	One
Components containing mercury	Examples: mercury in lamps, display backlights, scanner lamps, switches, batteries	None
Liquid Crystal Displays (LCD) with a surface greater than 100 square cm	Includes background illuminated displays with gas discharge lamps	None
Cathode Ray Tubes (CRT)		None



Item Description	Notes	Quantity of Items in Workstation
Capacitors / condensers that contain PCB / PCT		None
Electrolytic capacitors / condensers that measure greater than 2.5 cm in diameter or height		Four attached to the power supply PCB cards.
External electrical cables and cords		One
Gas Discharge Lamps		None
Plastics containing Brominated Flame Retardants		None
Components and parts containing toner and ink, including liquids, semi-liquids (gel/paste), and toner	Includes the cartridges, print heads, tubes, vent chambers, and service stations	None
Components and waste that contain asbestos		None
Components, parts, and materials that contain refractory ceramic fibers		None
Components, parts, and materials that contain radioactive substances		None

1.4 Required Tools

Table 1-3 lists the tools required for disassembly.

Table 1-3 Required Tools

Tool Description	Tool Size (if applicable)
Torx drivers, screwdriver, diagonal cutter	



2 Workstation Disassembly Procedures

Table 2-1 lists the steps to follow to disassemble the workstation.

Table 2-1 Workstation Disassembly

1.	Remove/disengage any security devices that prohibit opening the workstation.
2.	Disconnect the power cord from the electrical outlet and then from the workstation.
3.	Disconnect all peripheral device cables from the workstation.
4.	<p>Remove the access panel. Pull up on the handle ❶ and lift off the cover ❷.</p> 
5.	Disconnect all internal cables from system board, power supply, and other components.

6. Remove the system battery. Press on the release tab of the battery holder. Rotate the battery beyond the latch and lift it straight up.

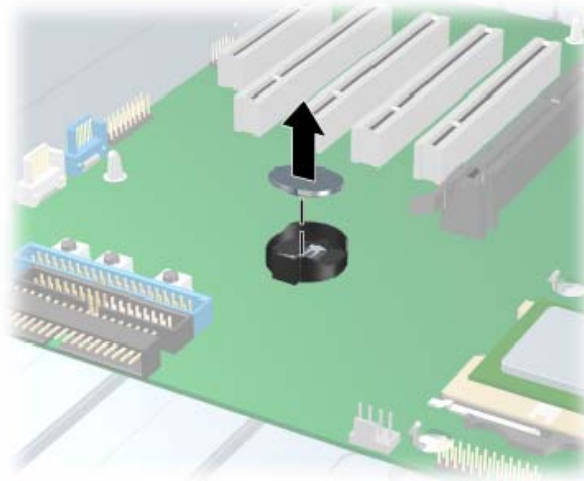
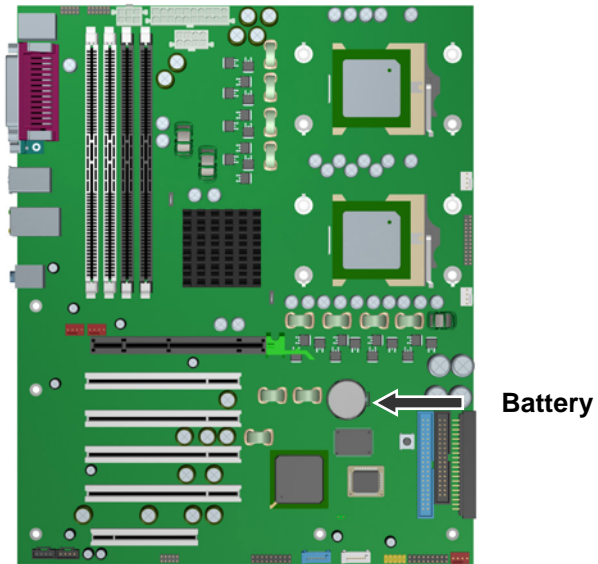

7. Remove the graphics card and any other expansion cards.
 If necessary, first remove the PCI Holder for short or tall cards. Press down on the holder arm ❶ while lifting up on the other side of the arm ❷.

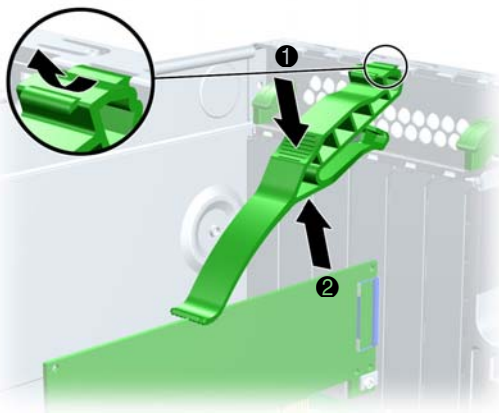

Short Card

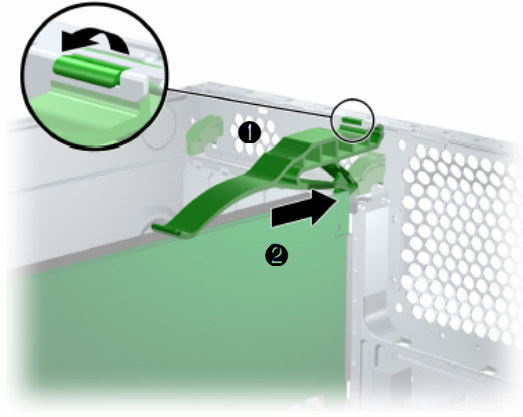

Tall Card

Remove the PCI retainer by pressing down on it, then out ❶.

Lift the PCI card out of the chassis ❷.

For PCI Express cards, first remove the power supply cable (not shown) if required. Then move the release lever ❸ and lift the card out of the chassis.

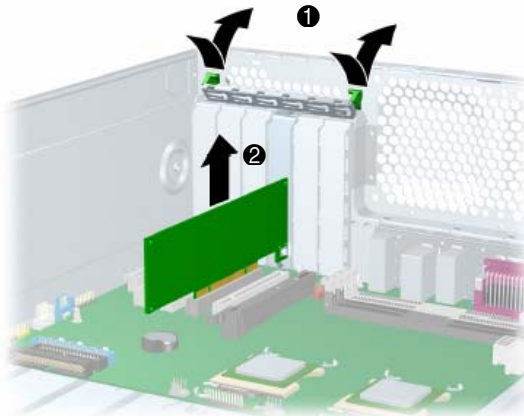

PCI Card

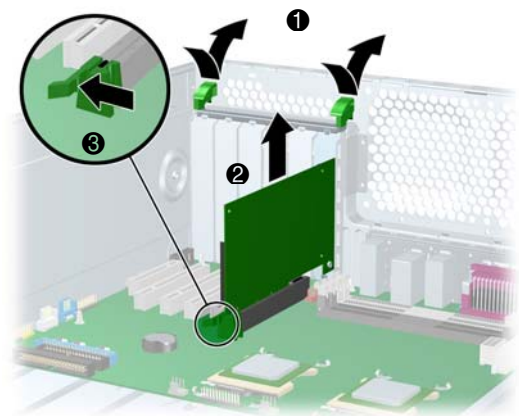

PCI Express Card

8. Remove the power supply from the chassis. Disconnect or cut electrical connections to the power supply. Remove the four screws securing the power supply to the workstation chassis
- 1 Slide the power supply toward the front, then lift up to remove it from the chassis
 - 2

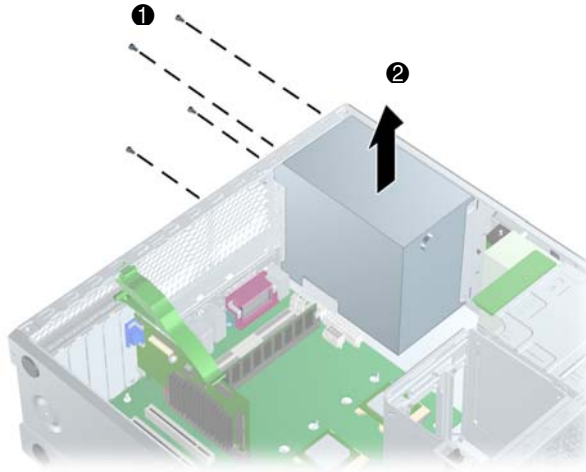

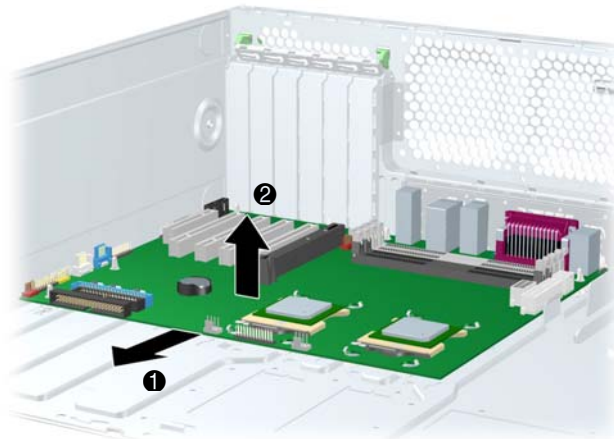

9. Remove the system board. Slide the board forward 1 to disengage the mounting standoffs from the chassis. Lift the board out of the chassis 2.



3 Power Supply Disassembly Procedures

Table 3-1 lists the steps to follow to disassemble the power supply.

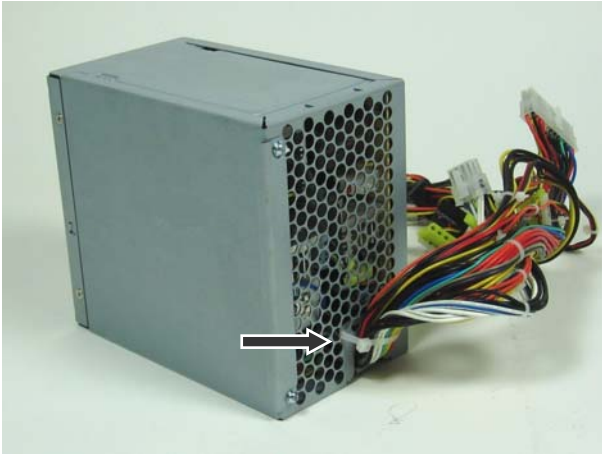
Table 3-1 Power Supply Disassembly

<p>1.</p>	<p>Use Table 1-2 to identify all components to be removed.</p>
<p>2.</p>	<p>Cut the cable tie at the rear of the unit.</p> 
<p>3.</p>	<p>Remove the four power supply chassis screws—two on each side of the rear.</p> 

4. Slide the chassis housing from the power supply unit.

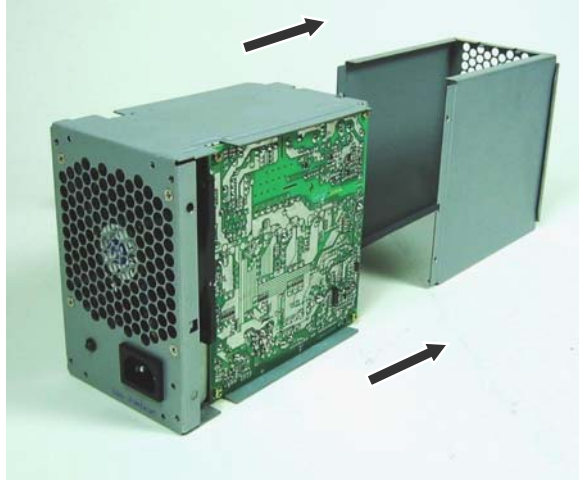

5. Remove the four screws from the corners of the first PCB card. Pull the card loose from the chassis.

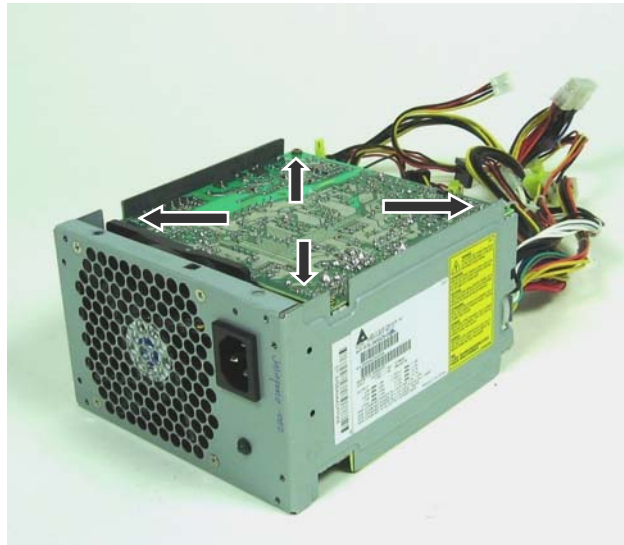

6. Unplug the connectors that connect the two PCB cards together. Remove the first PCB card from the chassis.

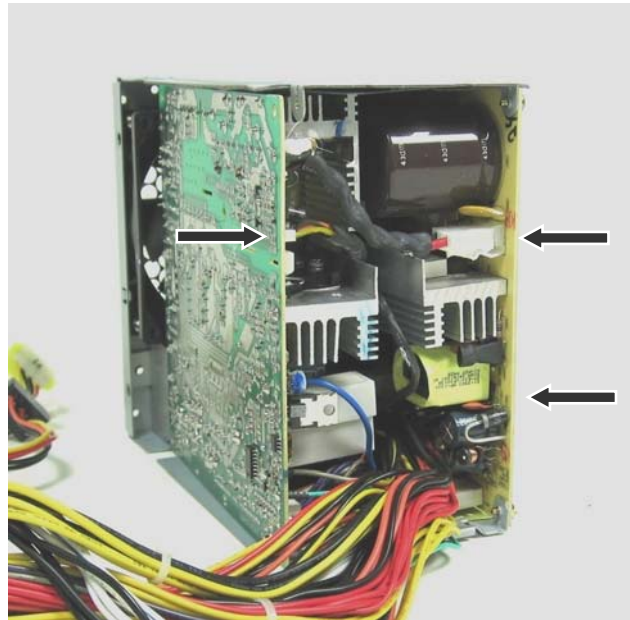

7. Ensure that all capacitors are safely discharged. Use a diagonal cutter to remove the desired components from both PCB cards. (Note that some components may need to be unsoldered if a diagonal cutter does not fit between the component and the PCB card.)



8. Dispose of all removed components according to regulatory requirements.



HP Part Number: 407686-001

© 2005 Hewlett-Packard Development Company, L.P. The HP Invent logo is a registered trademark of Hewlett-Packard Development Company, L.P.